

Application No: 1764/17

**Address: 115 Ipswich Street,
Stowmarket**





Verbal Updates:

- Confirmation and summary of any 3rd Party representations received not previously issued to members.
- Confirmation and summary of any consultee responses received not previously issued to members
- Confirmation of any changes to recommendation, conditions or reasons.

Site Location Plan

NOTES
DO NOT SCALE THE DRAWING
THIS DRAWING IS COPYRIGHT GARY JOHNS ARCHITECTS
ALL DIMENSIONS TO BE CONFIRMED ON SITE
ANY INCONSISTENCIES TO BE REPORTED TO ARCHITECT IMMEDIATELY



Ordnance Survey, (c) Crown Copyright 2014. All rights reserved. Licence number 100022432

Site Location Plan

1:1250

Rev	By /Date	Amendment	Chkd
-----	----------	-----------	------

44 SILVER STREET, ELY, CAMBRIDGESHIRE, CB7 4JF
TEL : +44(0)1353 665374
E-MAIL : info@johnsarchitects.co.uk
WEB : www.johnsarchitects.co.uk

CLIENT
Havebury Housing Partnership

PROJECT
Jokes, Ipswich Street, Stowmarket

DRAWING TITLE
Site Location Plan

Gary Johns Architects

SCALE (A1)	STATUS
1:1250	PLANNING

DRAWN	CHECKED	DATE
SR	GJ	18/06/2014

DRAWING NUMBER	REVISION
14-217 001	.

Block Plan/Site Layout



1:10

NO.	DESCRIPTION	DATE	BY
1	Issue for approval	12/11/10	GAJ
2	Issue for approval	12/11/10	GAJ
3	Issue for approval	12/11/10	GAJ
4	Issue for approval	12/11/10	GAJ
5	Issue for approval	12/11/10	GAJ
6	Issue for approval	12/11/10	GAJ
7	Issue for approval	12/11/10	GAJ
8	Issue for approval	12/11/10	GAJ
9	Issue for approval	12/11/10	GAJ
10	Issue for approval	12/11/10	GAJ
11	Issue for approval	12/11/10	GAJ
12	Issue for approval	12/11/10	GAJ
13	Issue for approval	12/11/10	GAJ
14	Issue for approval	12/11/10	GAJ
15	Issue for approval	12/11/10	GAJ
16	Issue for approval	12/11/10	GAJ
17	Issue for approval	12/11/10	GAJ
18	Issue for approval	12/11/10	GAJ
19	Issue for approval	12/11/10	GAJ
20	Issue for approval	12/11/10	GAJ

- Legend**
- External wall finish
 - Internal wall finish
 - Roof finish
 - Ground level
 - First floor level
 - Second floor level
 - Third floor level
 - Fourth floor level
 - Fifth floor level
 - Sixth floor level
 - Seventh floor level
 - Eighth floor level
 - Ninth floor level
 - Tenth floor level
 - Eleventh floor level
 - Twelfth floor level
 - Thirteenth floor level
 - Fourteenth floor level
 - Fifteenth floor level
 - Sixteenth floor level
 - Seventeenth floor level
 - Eighteenth floor level
 - Nineteenth floor level
 - Twentieth floor level

NO.	DESCRIPTION	DATE	BY
1	Issue for approval	12/11/10	GAJ
2	Issue for approval	12/11/10	GAJ
3	Issue for approval	12/11/10	GAJ
4	Issue for approval	12/11/10	GAJ
5	Issue for approval	12/11/10	GAJ
6	Issue for approval	12/11/10	GAJ
7	Issue for approval	12/11/10	GAJ
8	Issue for approval	12/11/10	GAJ
9	Issue for approval	12/11/10	GAJ
10	Issue for approval	12/11/10	GAJ
11	Issue for approval	12/11/10	GAJ
12	Issue for approval	12/11/10	GAJ
13	Issue for approval	12/11/10	GAJ
14	Issue for approval	12/11/10	GAJ
15	Issue for approval	12/11/10	GAJ
16	Issue for approval	12/11/10	GAJ
17	Issue for approval	12/11/10	GAJ
18	Issue for approval	12/11/10	GAJ
19	Issue for approval	12/11/10	GAJ
20	Issue for approval	12/11/10	GAJ

Gary Johns Architects

100-102 Ipswich Street, Ipswich, Suffolk IP1 3JG
 Tel: 01473 511111
 Fax: 01473 511112
 Email: gjohns@johnsarchitects.co.uk
 Web: www.gjohnsarchitects.co.uk

Project: [Redacted]
 Date: 12/11/10
 Scale: 1:100
 Sheet: 1 of 1
 Author: GAJ
 Checker: GAJ
 Date: 12/11/10
 Scale: 1:100
 Sheet: 1 of 1

Constraints map

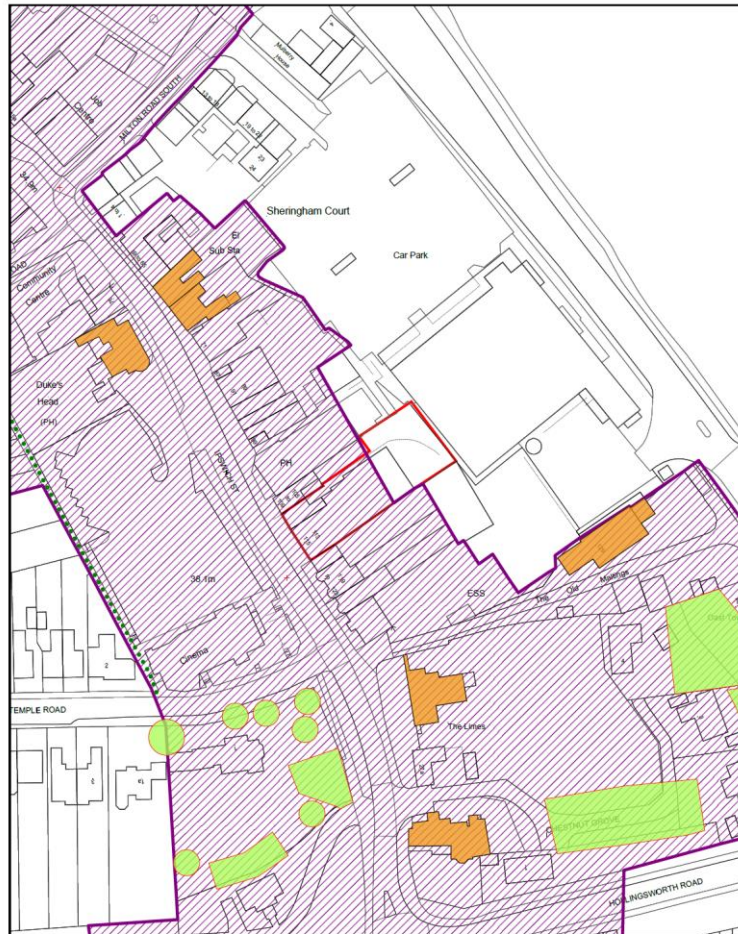

Title: Committee site plan
 Reference: 1764/17
 Site: 115 Ipswich Street
 Stowmatket



MID SUFFOLK DISTRICT COUNCIL
 131, High Street, Needham Market, IP6 8DL
 Telephone : 01449 724500
 email: customerservice@csduk.com
 www.midsuffolk.gov.uk



SCALE 1:1250

Reproduced by permission of
 Ordnance Survey on behalf of HMSO.
 © Crown copyright and database right 2017
 Ordnance Survey Licence number 100017810

Date Printed : 31/05/2017

Ground Floor Plan 1 of 2

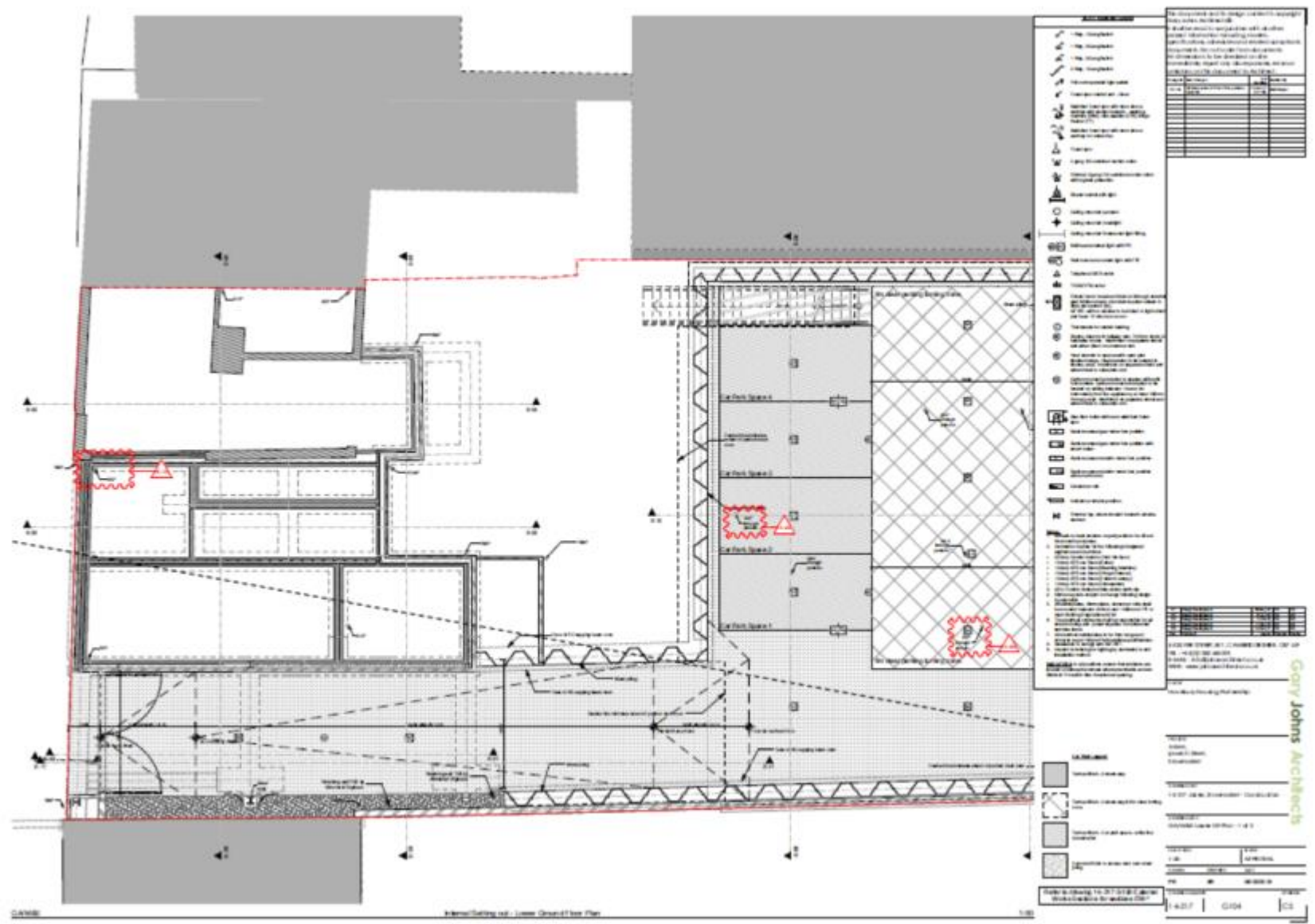



25 car parking spaces.
Extract from approved drawing
14-217-026-C from application 0683/15.

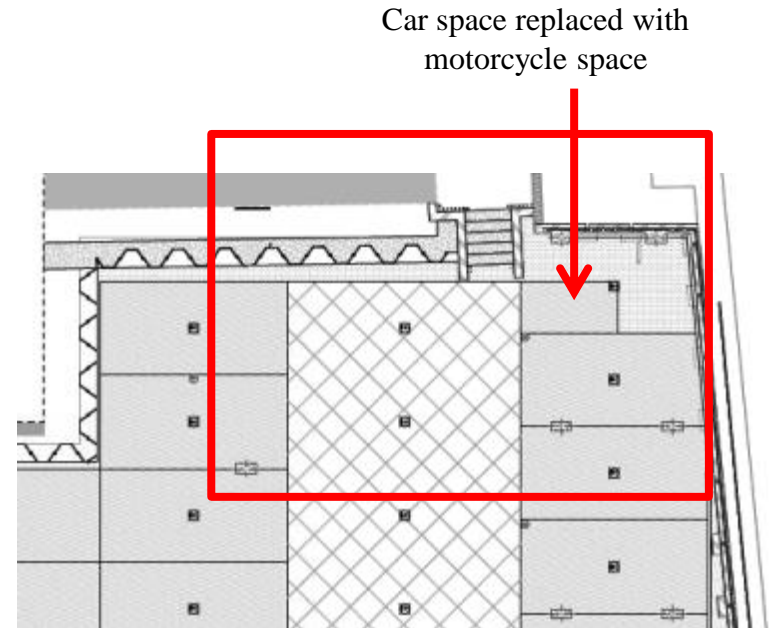

24 car parking spaces & 1 motorcycle space.
Extract from proposed drawing
14-217-G105-C5 from application 1764/17.



Final Summary

- Updates since writing the report
- Conclusions and Key Material Points
- Any further details around Recommendation, Conditions and Obligations.

Recommendation from Officers is for *Approval* as detailed within report.